

HOSEBED CAPACITIES  
 ① - 500' OF 2.50" D.J. POLY HOSE  
 ② - 1000' OF 4.00" D.J. POLY HOSE

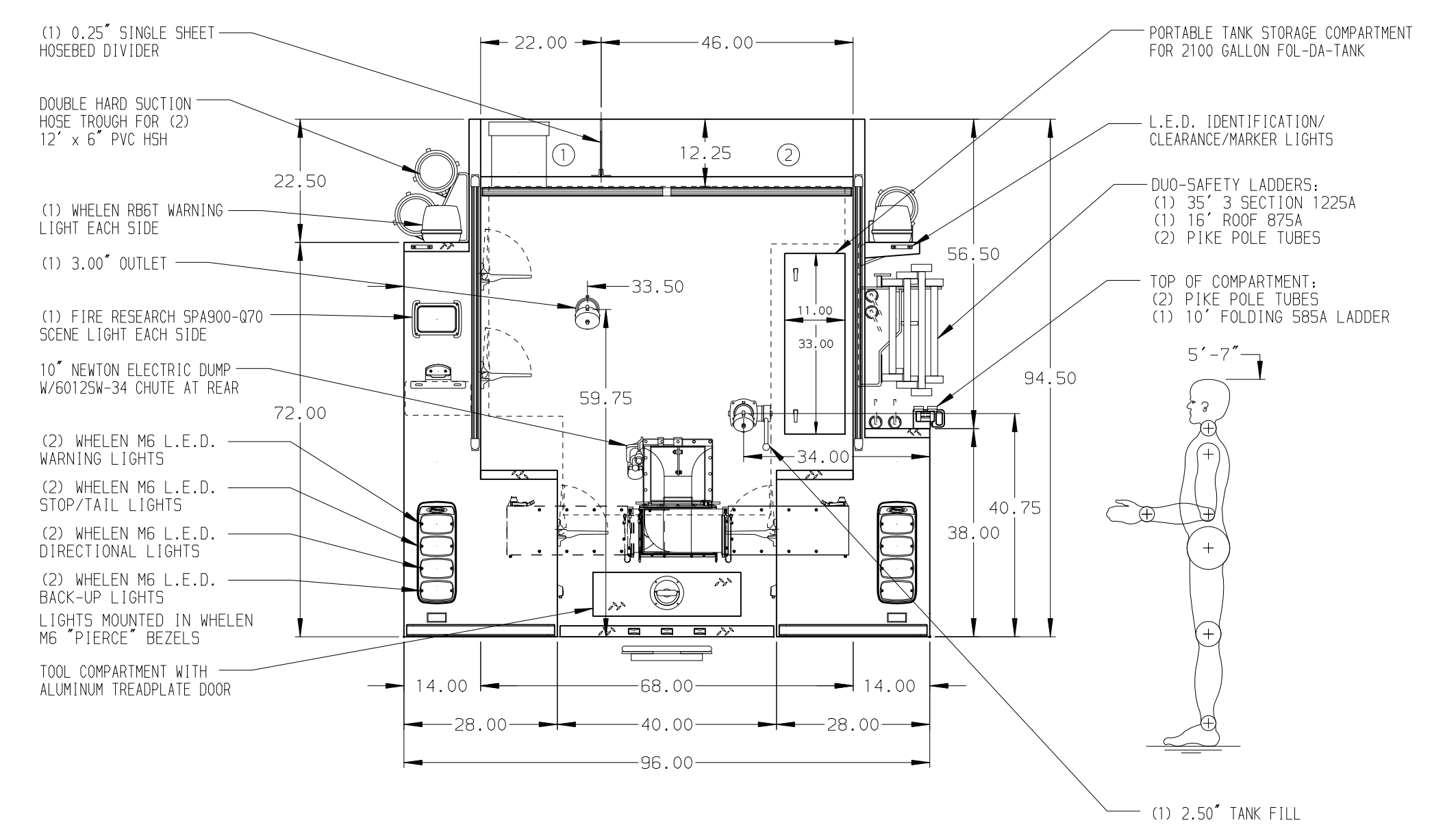

ALUMINUM BODY

NOTE  
 DIMENSIONS SHOWN ARE APPROXIMATE AND ARE SUBJECT TO MINOR DEVIATIONS AS MAY OCCUR OR BE NECESSARY IN CONSTRUCTION.  
 MINOR DETAILS NOT SHOWN.

- RUD AUTOMATIC TIRE CHAINS TO BE PROVIDED AT REAR
- PIERCE LOGO MUDFLAPS FRONT AND REAR
- MOUNTING BRACKETS AND WHEEL CHECKS PROVIDED BY DEALER
- BATTERY CHARGER LOCATED IN COMPARTMENT 03
- BATTERY CHARGE INDICATOR LOCATED ON D.S. SEAT RISER
- ONE 12V L.E.D. LIGHT STRIP LOCATED ON EACH SIDE IN THE HOSEBED
- PIERCE L.E.D. COMPARTMENT LIGHT STRIPS LOCATED PER SHOP ORDER
- SHELF TRACK LOCATED IN COMPARTMENT 03 & P3
- ONE FULL WIDTH/DEPTH PAINTED ADJUSTABLE SHELF IN COMPARTMENT \*\*\*\*TBD\*\*\*
- ONE ADJUSTABLE SLIDE-OUT TRAY WITH 20 SIDES IN COMPARTMENT \*\*\*\*TBD\*\*\*

CUSTOMER APPROVAL				Pierce MANUFACTURING INC.		JOB NO.	29326	
APPROVED BY: _____						SCALE	DATE	
DATE: _____						1:24		
			CHASSIS DATA	TITLE	1500-D-1800P 184" PUMPER TANKER, (3) XLAYS, GENERATOR DELUGE, NEWTON REAR DUMP, LADDERS ON PS SIDE SHEET		DRAWN BY	14AUG15
			MAKE	FOR	HOLLAND FIRE DISTRICT NO. 1 HOLLAND, NEW YORK		CHECKED BY	14AUG15
			PIERCE				SHEET SIZE	SHEET NO.
			MODEL	DWG NO.	29326AD		D	1 OF 1
REV	DATE	BY	CH	SABER FR				